

CLOSE TOLERANCE

Hinged Steel Belt Conveyors

TITANTM

CONVEYORS



MINIMUM PINCH POINTS

- Reduced Damage to Parts Load
- Reduce “Messy” Carry Over
- Reduce Premature Sidewing Damage
- Reduce Maintenance Costs with Detachable Sidewing

2-1/2” Pitch Close Tolerance HSB

4” Pitch Close Tolerance HSB

6” Pitch Close Tolerance HSB

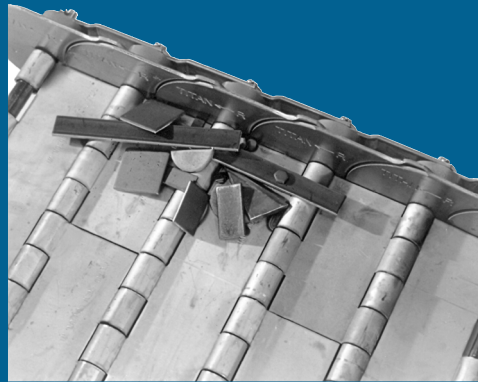

- 12 gauge apron with 1” high sintered metal sidewing
- 7/16” diameter axle
- 1-1/2” flat face through hardened sintered metal roller
- Plain, pimpled, perforated or impact apron
- 2500# chain pull with sidebar
- 1-1/4” diameter roller available

- Heavy duty 10 gauge apron with 3” high 7 gauge sidewing
- 1/2” diameter axle with 3/4” bushing
- 2” diameter single flange thru hardened sintered metal roller
- Plain, Pimpled, perforated or impact apron
- 4000# chain pull with sidebar
- 1-3/4” diameter single flange or flat face roller available

- Extra heavy duty 1/4” apron with 4” high 1/4” sidewing
- 3/4” diameter axle with heavy duty bushing
- 3” single flange thru hardened sintered metal roller
- Plain, pimpled, perforated or impact apron
- 8900# chain pull with sidebar
- 2-1/2” diameter flat face roller available
- Welded sidewing available

NOTE: Specifications subject to change without notice

HINGED STEEL BELT CONVEYOR

Applications and Specifications

HINGED STEEL BELT CONVEYOR

Titan Industries offers the Model 620 Hinged Steel Belt Conveyor when an application requires a low profile frame. The Model 620 can be furnished with either stamped low profile sidewings or the exclusive Titan powdered metal sidewing which virtually eliminates any gap between the sidewing and apron, thus reducing jamming problems. Standard belt widths are available from 6" to 36". The low profile frame (7" deep) will fit most requirements for a compact frame design. Marine type bushings at the infeed are standard on smaller units with optional 3 bolt flange or T-slot bearings available on larger units. The standard unit comes with top mount drive, 30, 45, or 60 degree inclines, structural channel support and a 1/2 H.P. 230/460/3/60 drive package for 30 F.P.M. Belt styles are available in plain, perforated or pimple aprons to suit the application.

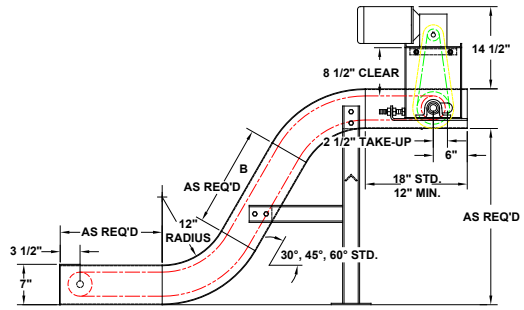

MODEL 620
SPECIFICATIONS

DRIVE:..... 1/2 H.P. 230/460/3/60
 SPEED: 30 F.P.M.
 FRAME: Formed 10 Gauge
 SPROCKETS: 5 Tooth, 4.25" P.D.
 BEARINGS: Grease Sealed-Drive End
 Marine Bushings-Infeed End
 SUPPORTS: Structural Channel
 PAINT: One Coat Industrial Enamel

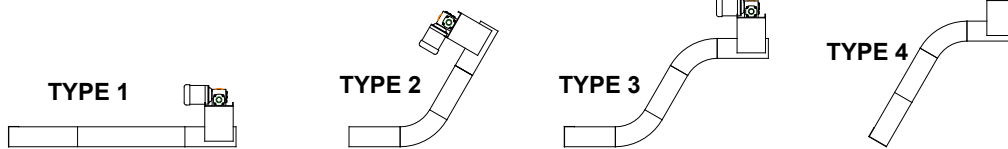

"PRO FEED" STEEL BELT PARTS FEEDER

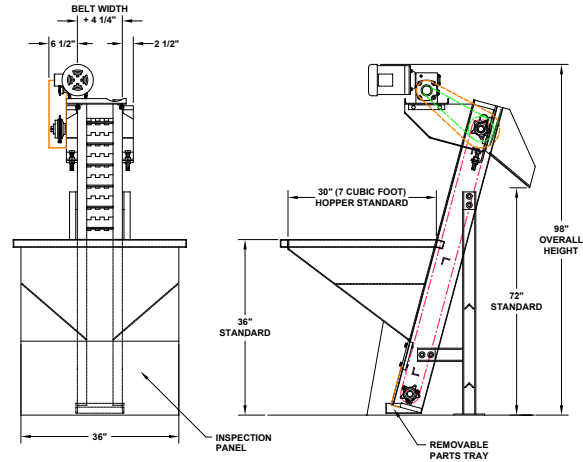

PRO FEED
SPECIFICATIONS

DRIVE:..... 1/2 H.P. 230/460/3/60
 SPEED: 10 F.P.M.
 FRAME: Formed 12 gauge
 SPROCKETS: 5 Tooth, 4.25 P.D.
 BEARINGS: Grease Sealed
 SUPPORTS: Square Tubing
 PAINT: One Coat Industrial Enamel



735 Industrial Loop Road • New London, WI 54961-9612
 920-982-6600 • Fax 920-982-7750 • Toll Free 800-558-3616
 Website: www.titanconveyors.com • Email: sales@titanconveyors.com

